



**TRIM HANDLING
UNITS FOR PAPER,
FILM & FOIL**



**Quirk
Korcraft**

Quickdraft meets your needs...precisely.

Trim removal will never be a problem in your plant if you put Quickdraft to work. Whether you collect it at the slitter location or convey it to a baler or grinder, Quickdraft is the dependable, maintenance-free way to get the job done.

Most trim can be moved in a continuous ribbon which makes it easier to bale or grind and also simplifies separating the material from the conveying air. We invite you to take advantage of our expertise to help you with your trim handling requirements.

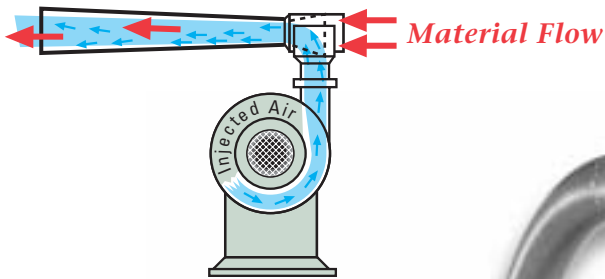

The Quickdraft Venturi

Superior design and precision manufacturing give the Quickdraft venturi its uniqueness in creating effective suction and efficient acceleration.

In this illustration, the red arrows indicate the material being forcefully induced. The blue arrows depict the injected air rapidly accelerating the flow.



Arrangement 'A'

45 DEGREE INSTALLATION

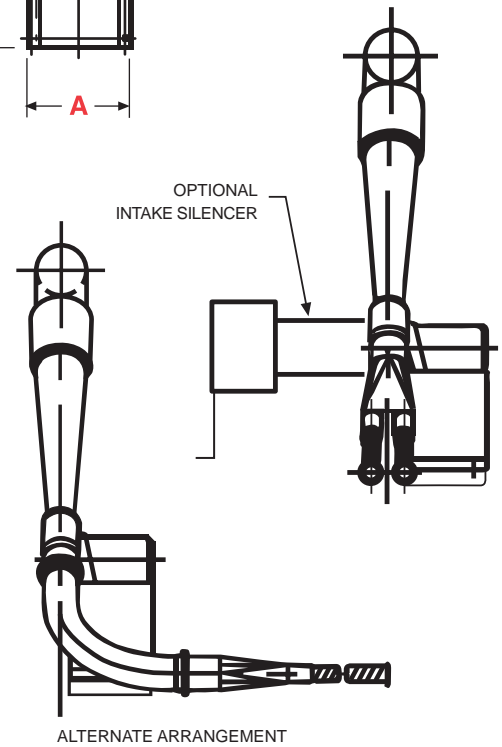
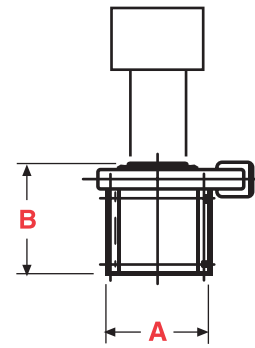
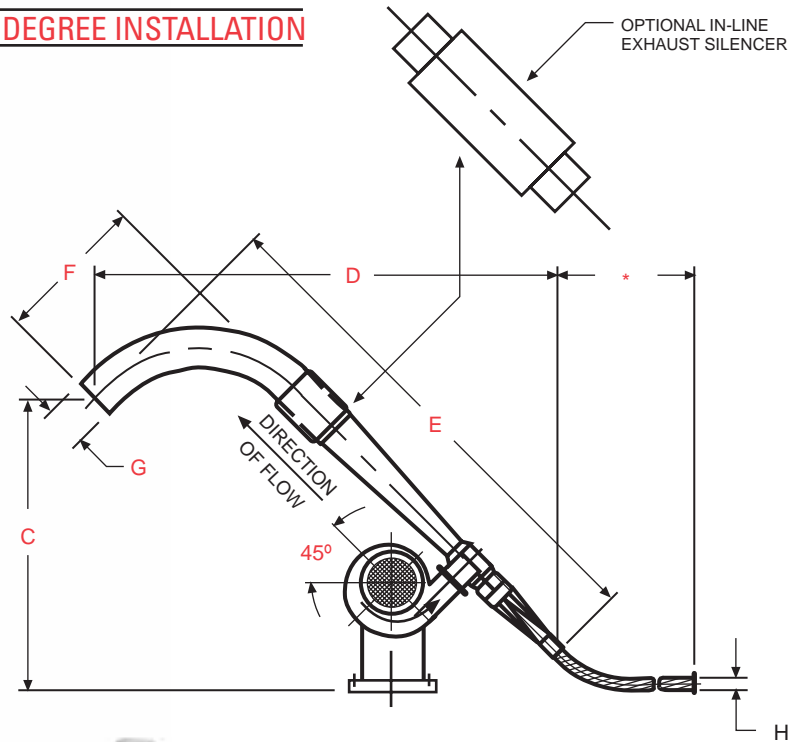

MODEL		A	B	C	D	E	F	G	H
MH355-	3/4 HP	12"	16 1/4"	47 5/8"	91 5/8"	95 1/2"	34"	5"	2"
	2 HP	12"	16 5/8"						
MH456-	1 HP	12"	16 1/2"	49 15/16"	92 1/4"	96 1/2"	34"	6"	2 3/4"
	1 1/2 HP	12"	16 1/4"	50 1/16"					
	2 HP	12"	16 5/8"	49 15/16"					
	3 HP	14"	18 5/8"	49 15/16"					
	5 HP	14"	18 5/8"	49 15/16"					
7 1/2 HP	14"	20 5/8"	49 15/16"						
MH557-	1 1/2 HP	12"	16 1/2"	58 3/8"	84 5/8"	95 1/2"	24 1/4"	8"	3 1/2"
	3 HP	14"	16 5/8"	57 1/8"					
	5 HP	14"	18 5/8"	57 1/8"					
	7 1/2 HP	16"	20 5/8"	57 1/16"					
	10 HP	16"	20 5/8"	61 1/8"					
MH658-	3 HP	14"	16 5/8"	61 5/16"	84 5/8"	95 1/2"	24 1/4"	8"	4"
	5 HP	14"	18 5/8"	61 13/16"					
	7 1/2 HP	16"	20 5/8"	57 7/8"					
	10 HP	16"	20 5/8"	59 1/8"					
	15 HP	16"	22 5/8"	65 7/8"					

* FLEXIBLE TUBING FURNISHED IN 25' LENGTHS. CUT TO LENGTH BY CUSTOMER.

Arrangement 'B'

VERTICAL INSTALLATION

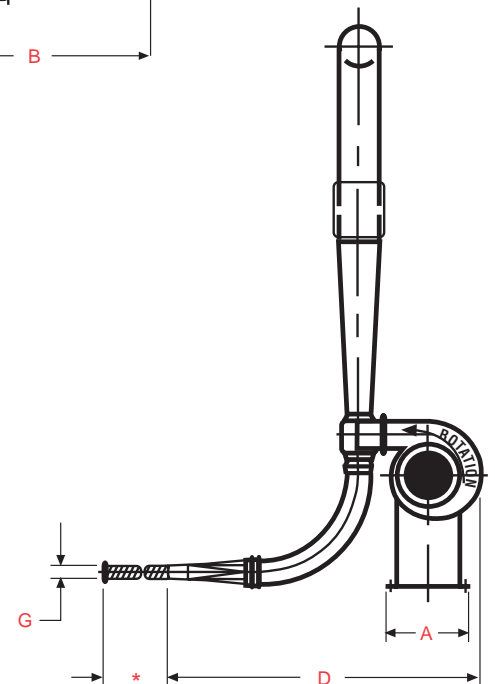
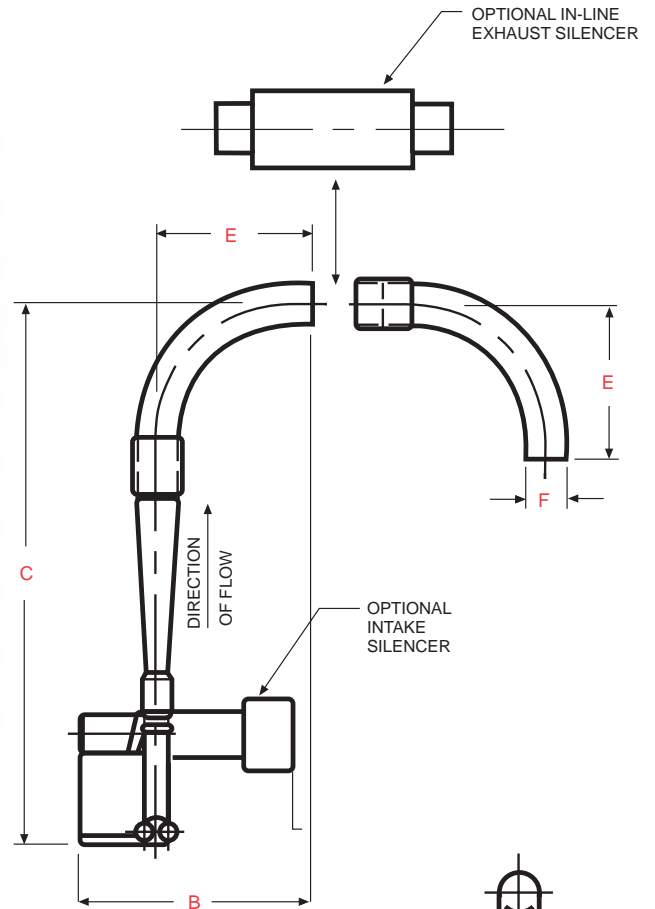

MODEL		A	B	C	D	E	F	G
MH355-	3/4 HP	12"	47 11/16"	95 1/4"	36 5/16"	34"	5"	2"
	2 HP	12"	47 3/4"	95 5/16"	43 13/16"			
MH456-	1 HP	12"	47 11/16"	98 7/16"	41 1/4"			
	1 1/2 HP	12"	47 11/16"	98 7/16"	41 1/4"			
	2 HP	12"	47 3/4"	98 1/4"	44 9/16"	34"	6"	2 3/4"
	3 HP	12"	49 3/4"	99 5/16"	46 13/16"			
	5 HP	14"	49 3/4"	101 1/8"	52 1/2"			
7 1/2 HP	16"	54 5/8"	100"	51 11/16"				
MH557-	1 1/2 HP	12"	40 3/4"	98 13/16"	46 5/8"			
	3 HP	14"	40"	99 3/16"	52 3/16"			
	5 HP	14"	40"	99 3/16"	52 3/16"	24 1/4"	8"	3 1/2"
	7 1/2 HP	16"	41 1/2"	98 5/8"	57 1/16"			
10 HP	16"	41 1/2"	98 5/8"	70 1/8"				
MH658-	3 HP	14"	39 1/2"	102 1/4"	53 5/8"			
	5 HP	14"	39 1/2"	103 5/16"	55 7/8"			
	7 1/2 HP	16"	41 1/2"	102 5/16"	58 9/16"	24 1/4"	8"	4"
	10 HP	16"	41 1/2"	102 5/8"	60 7/16"			
	15 HP	16"	43 1/2"	102 13/16"	75"			

* FLEXIBLE TUBING FURNISHED IN 25' LENGTHS. CUT TO LENGTH BY CUSTOMER.

Arrangement 'C'

HORIZONTAL INSTALLATION

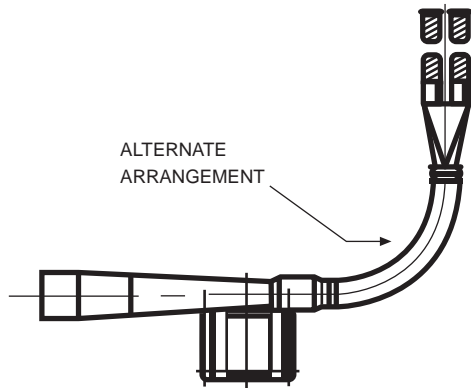
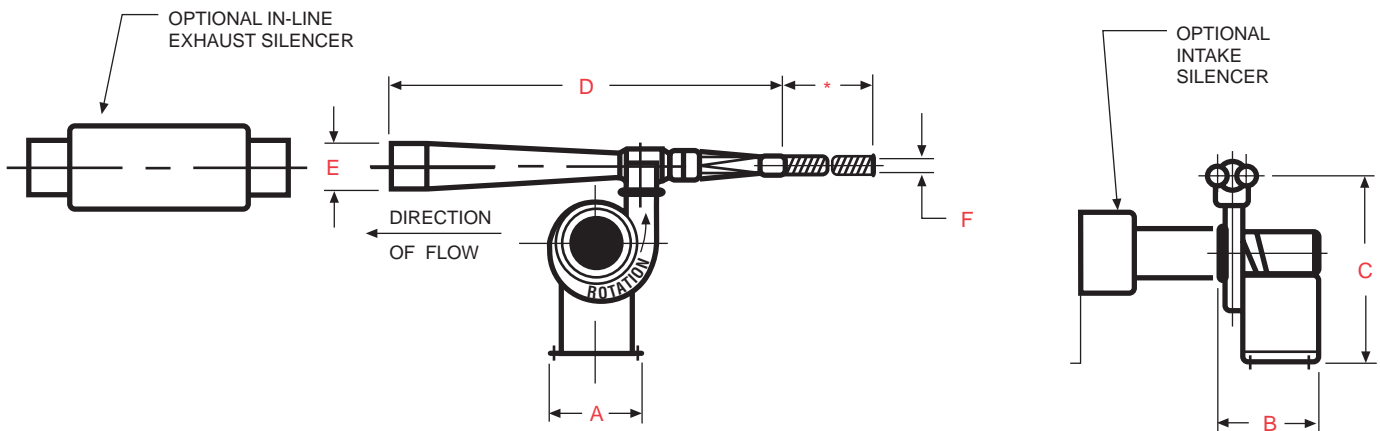

MODEL	A	B	C	D	E	F
MH355-	3/4 HP	12"	16 1/4"	25 1/8"	61 1/2"	5"
	2 HP	12"	16 5/8"	26 3/8"		
MH456-	1 HP	12"	16 1/2"	27 15/16"	62 1/2"	2 3/4"
	1 1/2 HP	12"	16 1/4"	28 3/16"		
	2 HP	12"	16 5/8"	27 7/8"		
	3 HP	14"	18 5/8"	29 5/8"		
	5 HP	14"	18 5/8"	30 15/16"		
7 1/2 HP	16"	20 5/8"	35"			
MH557-	1 1/2 HP	12"	16 1/2"	32 5/16"	70 1/4"	3 1/2"
	3 HP	14"	18 5/8"	33 1/2"		
	5 HP	14"	18 5/8"	33 1/2"		
	7 1/2 HP	16"	20 5/8"	31 7/8"		
10 HP	16"	20 5/8"	43 5/16"			
MH658-	3 HP	14"	18 5/8"	36 1/16"	71 1/4"	8"
	5 HP	14"	18 5/8"	37 13/16"		
	7 1/2 HP	16"	20 5/8"	34 11/16"		
	10 HP	16"	20 5/8"	36 1/16"		
	15 HP	16"	22 5/8"	48 3/16"		

* FLEXIBLE TUBING FURNISHED IN 25' LENGTHS. CUT TO LENGTH BY CUSTOMER.

Standard Silencing Equipment

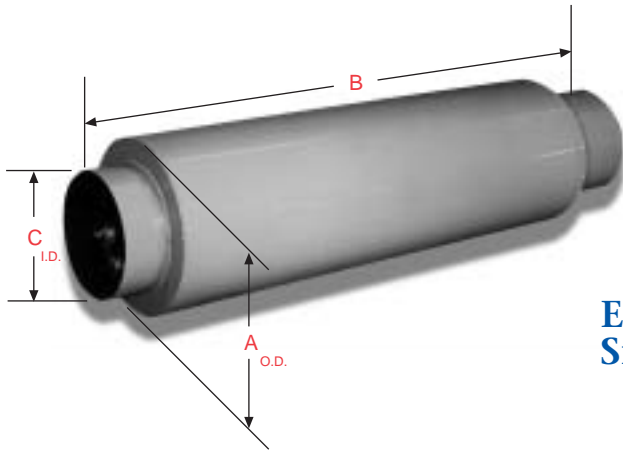

Eductor Exhaust Silencer

MODEL	A	B	C
MH355- 3/4 HP 2 HP	9"	36"	5"
MH456- 1 HP 1 1/2 HP 2 HP 3 HP 5 HP 7 1/2 HP	10"	42"	6"
MH557- 1 1/2 HP 3 HP 5 HP 7 1/2 HP 10 HP	ARRGT "A" & "C" 11" ARRGT "B" 12"	48"	ARRGT "A" & "C" 7" ARRGT "B" 8"
MH658- 3 HP 5 HP 7 1/2 HP 10 HP 15 HP	12"	48"	8"

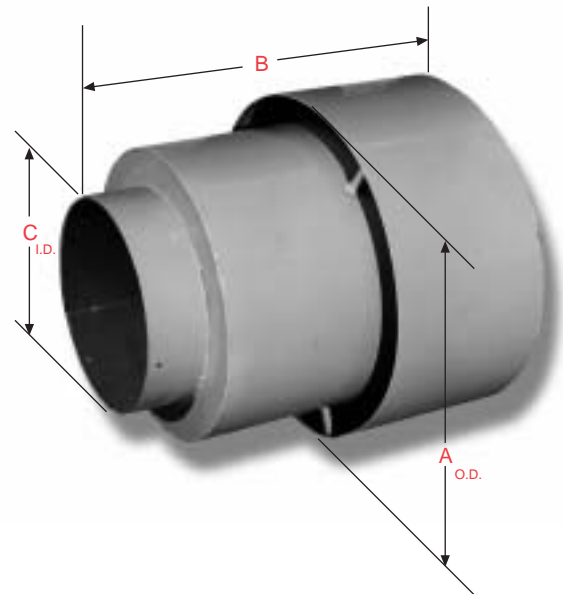

Blower Intake Silencer

MODEL	A	B	C
MH355- 3/4 HP 2 HP	16 1/2" 21 1/2"	15" 23 3/4"	7 7/8" 11"
MH456- 1 HP 1 1/2 HP 2 HP 3 HP 5 HP 7 1/2 HP	16 1/2" 21 1/2" 21 1/2" 21 1/2" 25" 25"	15" 23 3/4" 23 3/4" 23 3/4" 35" 35"	9" 9 7/8" 11" 12 7/8" 11" 11"
MH557- 1 1/2 HP 3 HP 5 HP 7 1/2 HP 10 HP	16 1/2" 21 1/2" 21 1/2" 25" 27"	15" 23 3/4" 29 3/4" 35" 46"	9" 12 7/8" 12 7/8" 14 1/2" 12 7/8"
MH658- 3 HP 5 HP 7 1/2 HP 10 HP 15 HP	21 1/2" 21 1/2" 25" 25" 27"	23 3/4" 29 3/4" 35" 41" 46"	11" 11" 14 1/2" 11" 12 7/8"

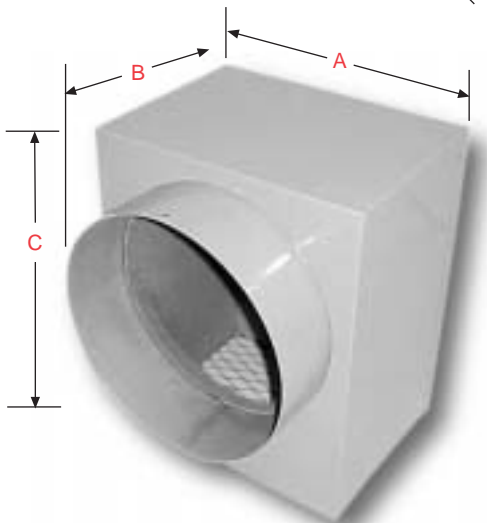

Acoustic Lined Blower Inlet Hood

MODEL	A	B	C
MH355- 3/4 HP 2 HP	10" 13"	12" 14"	15" 15"
MH456- 1 HP 1 1/2 HP 2 HP 3 HP 5 HP 7 1/2 HP	11" 12" 13" 15" 13" 13"	13" 13" 14" 15" 14" 14"	14" 17" 15" 18 1/2" 15" 15"
MH557- 1 1/2 HP 3 HP 5 HP 7 1/2 HP 10 HP	11" 15" 15" 17" 15"	13" 15" 15" 16" 15"	14" 18 1/2" 18 1/2" 19 1/2" 18 1/2"
MH658- 3 HP 5 HP 7 1/2 HP 10 HP 15 HP	13" 13" 13" 17" 15"	14" 14" 14" 16" 15"	15" 15" 15" 19 1/2" 18 1/2"

Accessories



Collection Receptacle

This woven polyester bag assembly provides a simple, flexible, convenient and effective means for dissipating the conveying air while collecting the trim or waste material. A convenient zipper is included. The mildew-resistant unit is highly tear resistant.

Volume Damper

Trim conveying velocity can be controlled easily by using a Quickdraft volume damper. The automatic unit is recommended for applications where web speed may vary. In all cases, matching suction pressure to the speed of slitting operation reduces flutter, attenuates noise, and minimizes energy consumption.



Motor Starter

UL listed motor starters are available to comply with customer's stipulations. Modular components accommodate a wide variety of preferences in a broad selection of NEMA enclosures.



Perforated Elbow Separators

Standard and customized perforated elbows are available to exhaust the conveying air while delivering trim to a collection receptacle. The perforations are precision engineered for optimum separation of air and material.

QUICKDRAFT Portable Problem Solver



Transportation Arrangement

Quickdraft has developed a fully portable, completely self-contained pneumatic conveying unit for handling trim. It offers a fast, efficient solution to trim removal when and where you need it at a minimum cost.

The dependable, maintenance free unit is equipped with blower intake silencer to guarantee quiet operation.

It uses less horsepower, yet does more work than other eductor units thanks to Quickdraft's unique method of injecting air into the eductor plenum.

The lightweight unit can be easily moved by one person. When the unit is in use, the truck handle is removed to provide a solid platform. When not in use, the flexible pickups are clipped on the unit for quick storage.

Like all Quickdraft units, the portable problem solver eliminates the need for many accessories normally associated with conventional material handling systems.

A 25-foot cord with male plug is available.

Set-up, start-up and operation are engineered to provide maximum efficiency and performance.

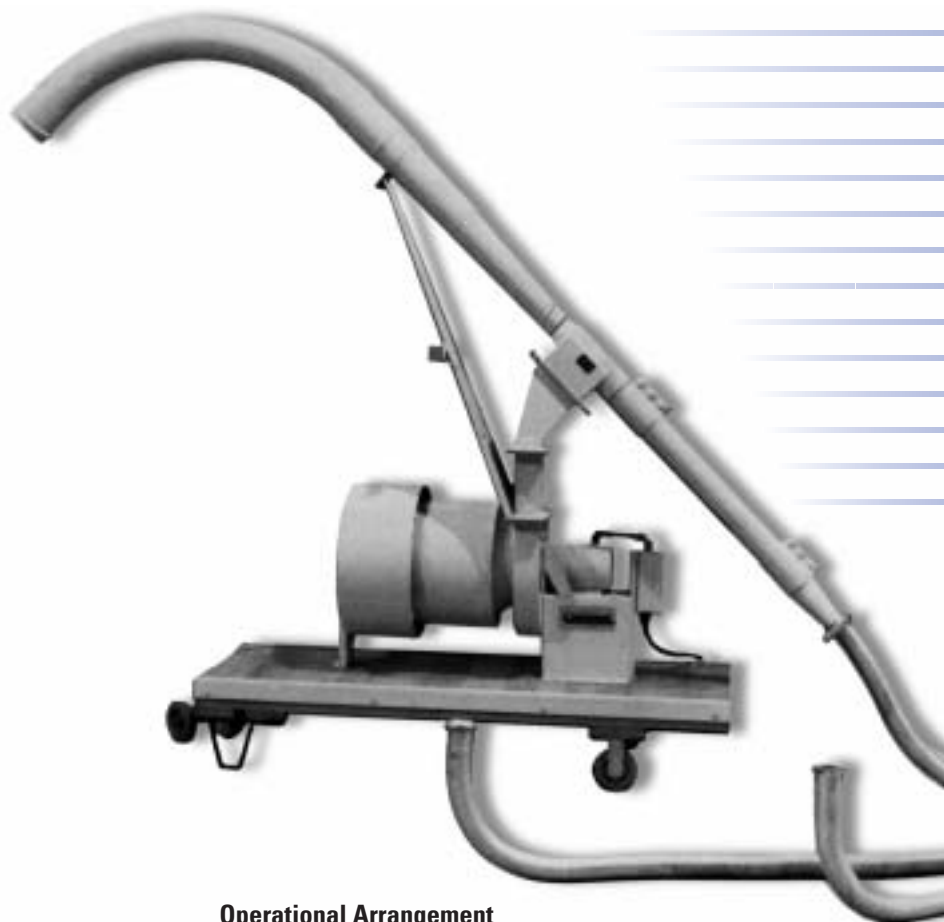

Operational Arrangement



TRIM HANDLING QUESTIONNAIRE

QUICKDRAFT
1525 Perry Drive, S.W.
Canton, Ohio 44710

Telephone: (330) 477-4574
Fax: (330) 477-3314
www.quickdraft.com
info@quickdraft.com

Name _____ Title _____

Company _____

Address _____

How did you learn about Quickdraft?

Date _____ Phone _____ Fax _____

- Prior experience Referral Quickdraft Web Site E-mail Web Site
- Trade Show (name) _____ Magazine Ad (name) _____
- Post Card Mailing (sponsor) _____ Other (please specify) _____

SECTION A

1. Material to be conveyed _____
2. No. of Machines _____ 3. Trims Per Machine _____ 4. Max. Speed _____
5. Max. Trim Width _____ 6. Max. Web Width _____ 7. Min. Web Width _____
8. Max. Thickness or Basis Weight of Material _____
9. Desired Configuration: Arrangement A Arrangement B Arrangement C
 Other (please describe) _____

Note: Custom engineered systems and configurations are available. Please contact us for details.

10. Trim capture mechanism: Flexible duct with flared entries furnished with unit
 Other (please describe) _____
11. Trim Receiver: Collection bag to be furnished by Quickdraft
 Other (describe) _____
13. Material Sample Enclosed? Yes No (If No, is sample available? Yes No)

SECTION B

1. Unit location: a) Inside b) Outside
2. Maximum noise level permissible (in dB) _____
3. Ambient considerations (please describe) _____

SECTION C

1. Mild steel construction is standard. If special needs exist, please specify:
2. 25 feet of flexible tubing is furnished by Quickdraft
If other lengths or types are desired, please specify _____
3. Power Supply: AC voltage _____ Phase _____ Frequency _____
4. Required motor enclosure: TEFC Other, (please describe) _____

The Quickdraft Advantage...

Eighteen models in one of three arrangements plus the portable design provide unprecedented selection, versatility, efficiency and economy.

Typical accessories include a wide assortment of silencers, volume dampers, motor starters, perforated elbows and collection receptacles.

All models in all configurations include the unique Quickdraft eductor which provides efficiency and unparalleled performance.

Engineered Systems

Wherever applicable, Quickdraft designers and engineering staff provide complete systems which may include collection assemblies, choppers and cutters, blowers, ducting, structures, air/material separators, dust collectors and all of the means required for a fully functional turn-key operation. Advanced design concepts such as the Quickdraft cylindrical receiver (QCR) and the patented Trimvac system are available.

For special materials, dimensions, speeds and power factors not listed, please contact us.

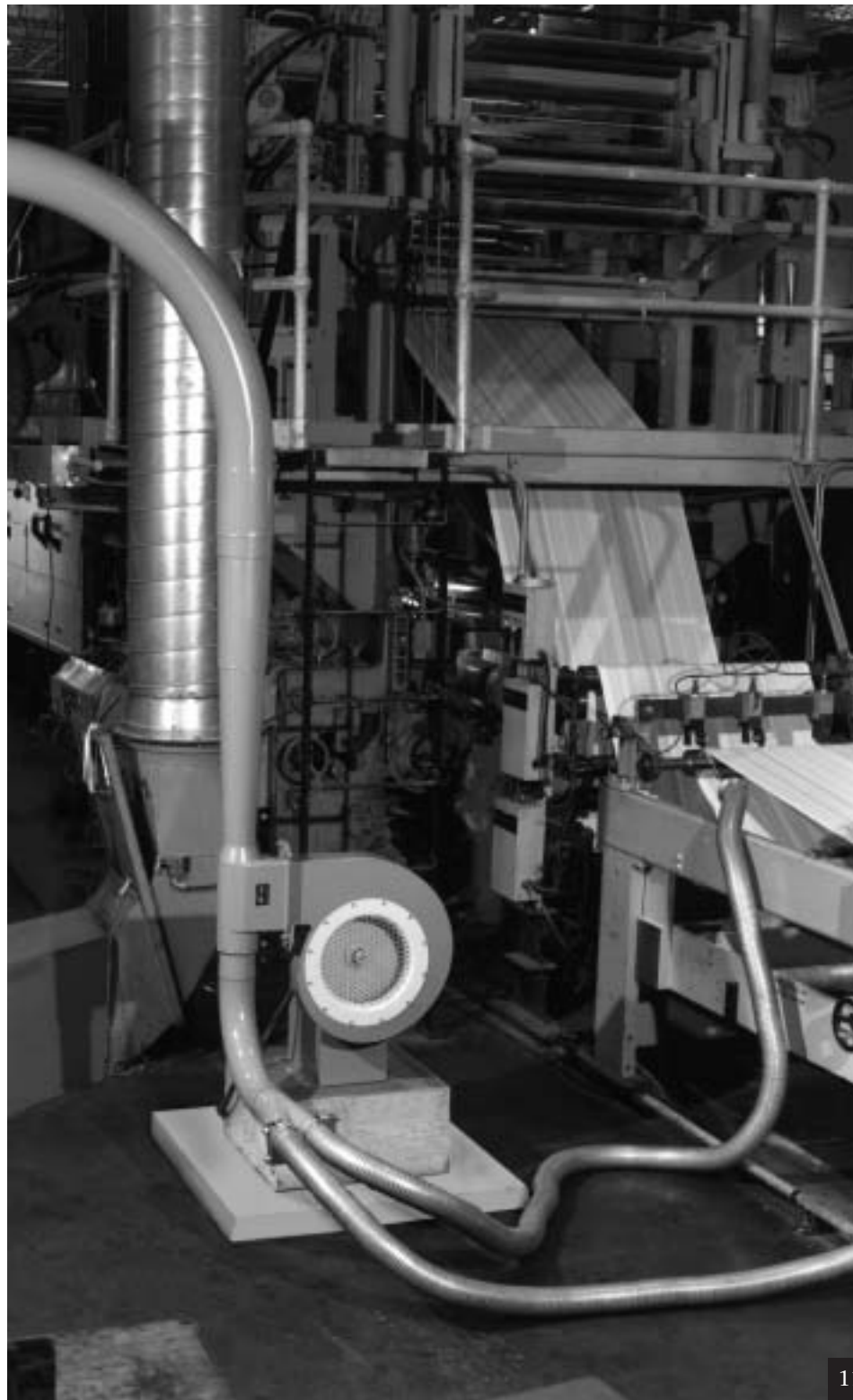

Standard Trim Units

MODEL	H.P.	Trim Width (in.)	Trim Speed (FPM)
MH355-	3/4 HP	1"	500
MH355-	2 HP	1 1/2"	1000
MH456-	1 HP	2"	300
MH456-	1 1/2 HP	2"	500
MH456-	2 HP	2 1/4"	500
MH456-	3 HP	2 1/4"	750
MH456-	5 HP	2 1/4" to 3	1000
MH456-	7 1/2 HP	2 1/4" to 3	2000
MH557-	1 1/2 HP	2 3/4"	300
MH557-	3 HP	3"	750
MH557-	5 HP	3"	1000
MH557-	7 1/2 HP	3" to 4	1500
MH557-	10 HP	3" to 4	2500
MH658-	3 HP	3 1/2"	500
MH658-	5 HP	3 1/2"	1000
MH658-	7 1/2 HP	3 1/2" to 5	1500
MH658-	10 HP	3 1/2" to 5	2500
MH658-	15 HP	3 1/2" to 5	3500



THE QUICKDRAFT GUARANTEE

The Quickdraft guarantee goes far beyond the usual product repair or replacement policy for "defects in workmanship or material." It can extend to on-site system performance. The Quickdraft performance guarantee is backed by a tradition of quality which began in 1953 and has served a myriad of satisfied customers across a broad spectrum of industries. It has established Quickdraft as the premier source for trim handling equipment.

AVAILABLE SERVICES

Quickdraft personnel and representatives are always available to answer your questions and help with your pneumatic conveying requirements. Our engineering staff can provide objective, on site technical evaluations, detailed purchasing specifications and professional start-up services. In addition, expert technicians are on call whenever repairs or modifications are needed.

Extensive test facilities are maintained to simulate job site conditions whenever special products or applications are required. This capability is also available to assess special customer materials or performance requirements.

VISIT OUR WEB SITE AT...

www.quickdraft.com or send e-mail to info@quickdraft.com

For More Information:



Division of C.A. Litzler Co., Inc.
1525 Perry Dr. S.W. Canton, Ohio 44710-1098
Telephone: (330) 477-4574 Fax: (330) 477-3314